

DRILL TYPE ANCHOR INFORMATION (DRILL TYPE ANCHORS PROVIDED WITH THE SCALE)

FOR THE CORNER STANDS (16 REQUIRED)

FOR THE FULCRUM & LC STANDS (10 REQUIRED)

5/8" DIA X 6" STUD TYPE ANCHORS

DRILL DIA 5/8", DRILL DEPTH 3 1/2"

ANCHOR DETAIL

TYPICAL SIDE ELEVATION OF SCALE INSTALLATION

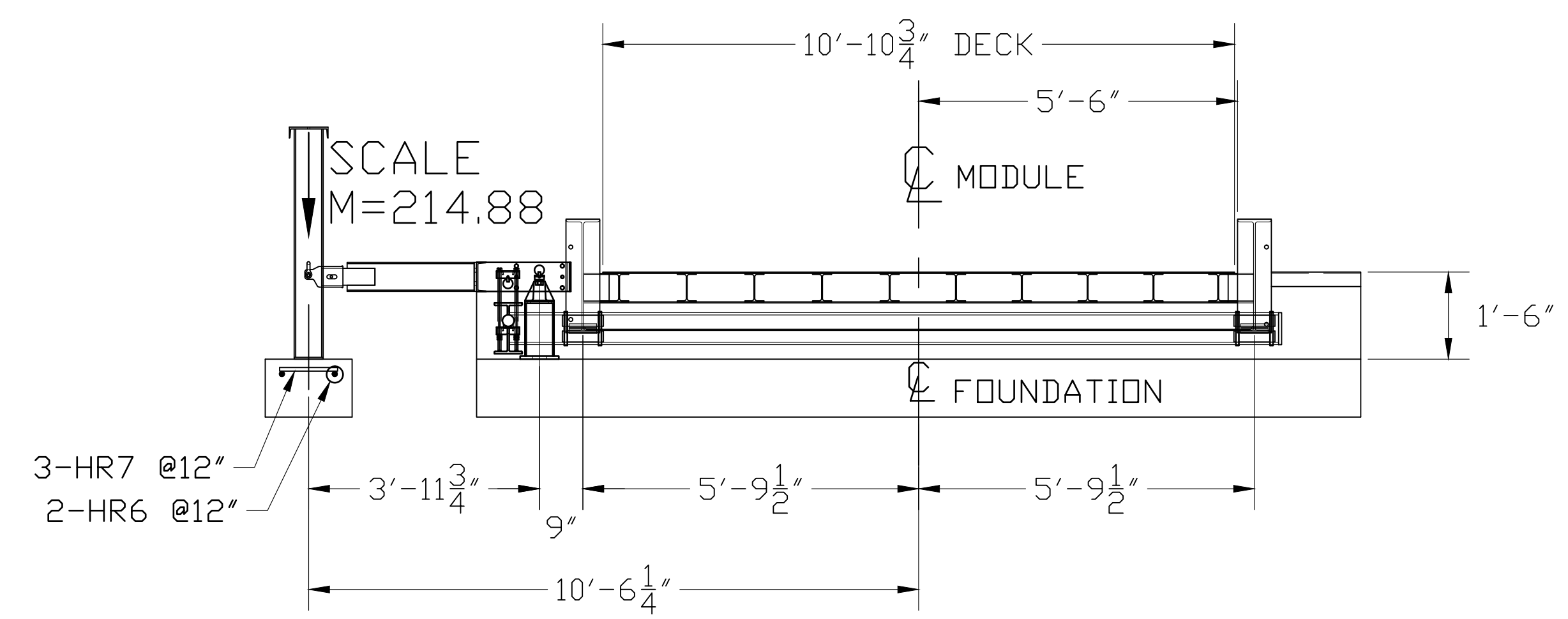
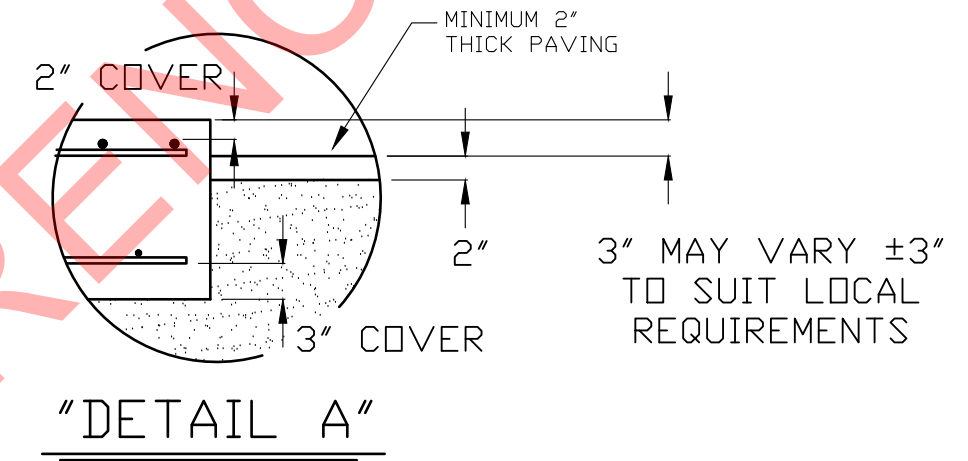

- NOTES:
- FOUNDATION DESIGN IS BASED ON A MINIMUM SOIL BEARING CAPACITY OF 3000 LB/SQ. FT. FOR SOIL CONDITIONS WHICH DO NOT MEET THIS SPECIFICATION, CONSULT WITH THE THURMAN SCALE COMPANY.
  - THE FOUNDATION SHALL BE INSTALLED AT AN ELEVATION AND LOCATION TO INSURE ADEQUATE DRAINAGE AWAY FROM SCALE. A PERIMETER TRENCH AND AGGREGATE BASE MAY BE ADDED IF DRAINAGE IS NOT SUFFICIENT TO MAINTAIN 3000 LB/SQ. FT. BEARING CAPACITY.
  - BOTTOM OF FOOTERS SHOULD EXTEND BELOW THE FROST LINE. AN 18 INCH FOOTER DEPTH IS MINIMUM.
  - N.I.S.T. H-44 REQUIREMENTS AND LOCAL WEIGHTS AND MEASURES REGULATIONS MAY REQUIRE INSTALLATION PARAMETERS SOMEWHAT DIFFERENT THAN ILLUSTRATED ON THIS PLAN. IN ORDER TO INSURE COMPLIANCE, CONSULT THE LOCAL WEIGHTS & MEASURES OFFICE PRIOR TO CONSTRUCTION.
  - CONCRETE OF 4000 PSI MINIMUM COMPRESSIVE STRENGTH IS REQUIRED, WITH 5-7% AIR ENTRAINMENT. VIBRATE CONCRETE WHEN POURING. FOLLOW LATEST ACI REQUIREMENTS FOR MATERIALS AND CONSTRUCTION. DO NOT CAST UNLESS TEMPERATURE IS ABOVE 40 DEGREES FAHRENHEIT.
  - PIERS MUST BE LEVEL AND IN THE SAME PLANE WITHIN ±1/8 INCH.
  - EXCAVATION, FORMS, REINFORCING STEEL, GUARD POSTS, AND CONCRETE FURNISHED BY OTHERS.
  - DO NOT PLACE REBAR IN CLOSE PROXIMITY OF ANCHOR BOLTS.

FOUNDATION REBAR SCHEDULE  
ASTM A615 GRADE 60

MARK	QTY.	SIZE	LENGTH	WT.	REMARKS
HR1	32	#4	9'-6"	204	(16) EA. APPROACH LONG.
HR2	96	#4	15'-0"	962	(14) EA. APPROACH LAT; (17) EA. PIER LAT.
HR3	128	#4	3'-0"	257	(32) EA. PIER LONG.
HR4	2	#4	5'-0"	7	(2) DUAL FULCRUM PIER LONG.
HR5	12	#4	1'-4"	11	(3) EA. FULCRUM PIER LAT.
HR6	6	#4	2'-0"	9	(2) EA. FULCRUM PIER & LC PIER LONG.
HR7	3	#4	1'-0"	3	(3) LC PIER LAT.
VR1	64	#4	2'-6"	107	(32) EA. END WALL VERTICAL.
TOTAL WT.					1560

CONCRETE REQUIREMENTS  
4000 PSI

AREA	QTY. (CU. YDS.)
PIERS AS SHOWN	12
APPROACHES	9
FLOOR AT 2" THICK	6
OPTIONAL APPROACH SUPPORTS	3
TOTAL	30.0

- REINFORCING STEEL NOTES:
- REINFORCING STEEL SHALL BE FREE OF ALL MUD, DEBRIS, CEMENT GROUT, LOOSE RUST, GREASE, AND OIL.
  - TACK WELDING OF BARS IS PROHIBITED.

THIS DRAWING IS SUPPLIED AS CHECKED BELOW:

REFERENCE (ESTIMATES ONLY, NOT FOR CONSTRUCTION)

CERTIFIED FOR CONSTRUCTION, THURMAN #

CUSTOMER: \_\_\_\_\_ DATE: \_\_\_\_\_

CUSTOMER APPROVAL, RETURN ONE COPY. (ORDER ON HOLD UNTIL SIGNED COPY IS RETURNED)

APPROVED AS DRAWN, APPROVED BY: \_\_\_\_\_ DATE: \_\_\_\_\_

APPROVED AS NOTED, APPROVED BY: \_\_\_\_\_ DATE: \_\_\_\_\_

LET	BY	DATE	REVISION

**THURMAN SCALE**  
COLUMBUS, OH

8140 60K CLC  
70' X 11' FOOTINGS  
FOUNDATION (4 SECTION)

DATE: 10/26/12

SCALE: N/A SHEET 1 OF 1

DRAWN BY: JCR MODEL: \_\_\_\_\_

CHECKED BY: LC DRAWING NUMBER: 92535-FT

APPROVED BY: LC REVISION: 0

MATERIAL: A36 FINISH: N/A

UNLESS OTHERWISE SPECIFIED DIMENSIONS ARE IN INCHES TOLERANCES: FRACTIONS ±1/8" ANGLES ±1° DECIMAL ±.005 2-PLACE DECIMAL ±.005 ±.005 3-PLACE DECIMAL ±.005 ±.005 ±.005

THE MATERIAL AND INFORMATION CONTAINED HEREIN IS CONFIDENTIAL AND IS THE PROPERTY OF THURMAN SCALE COMPANY AND IS NOT TO BE USED, DISCLOSED, COPIED, TRANSFERRED, OR REPRODUCED WITHOUT THE PRIOR WRITTEN PERMISSION OF THURMAN SCALE COMPANY.